

9. Front Outer Handle

A: REMOVAL

- 1) Raise the glass assembly - front door to the top position.
- 2) Remove the trim panel - front door. <Ref. to EI-72, FRONT DOOR, REMOVAL, Door Trim.>
- 3) Remove the sealing cover - front door.

CAUTION:

- **Carefully remove the butyl tape. Excessive force will easily break the sealing cover - front door.**
- **If the sealing cover - front door gets broken, replace it with a new part.**
 - (1) Remove the screw to remove the bracket - door trim front.
 - (2) Disconnect connectors.
 - (3) Carefully remove the butyl tape to remove the sealing cover - front door.

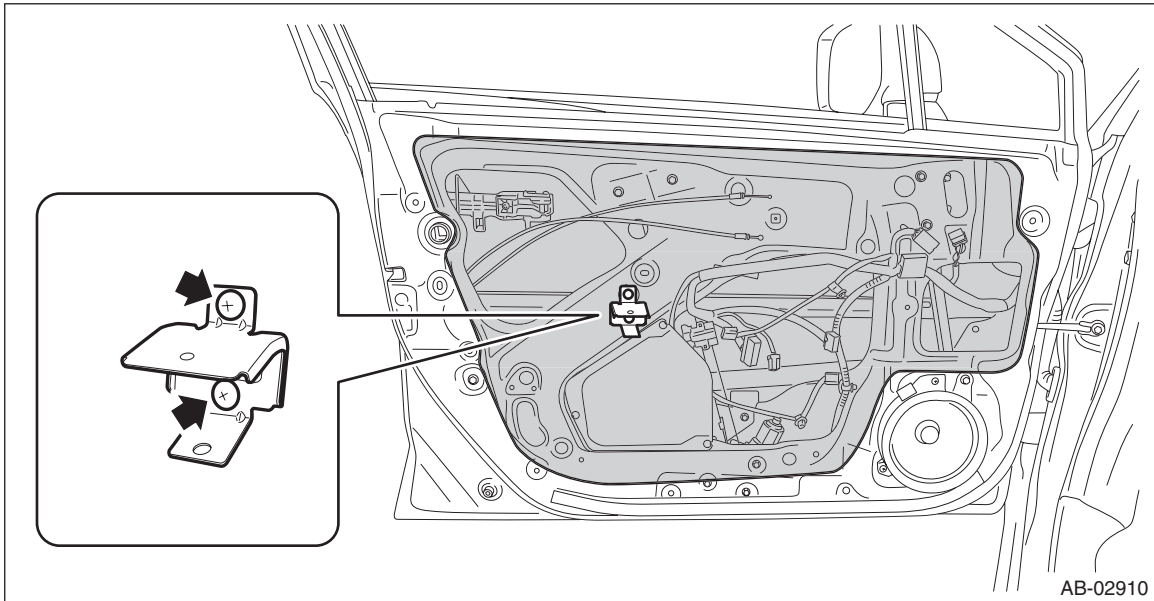

- 4) Remove the holder of the frame assembly - front door outer.

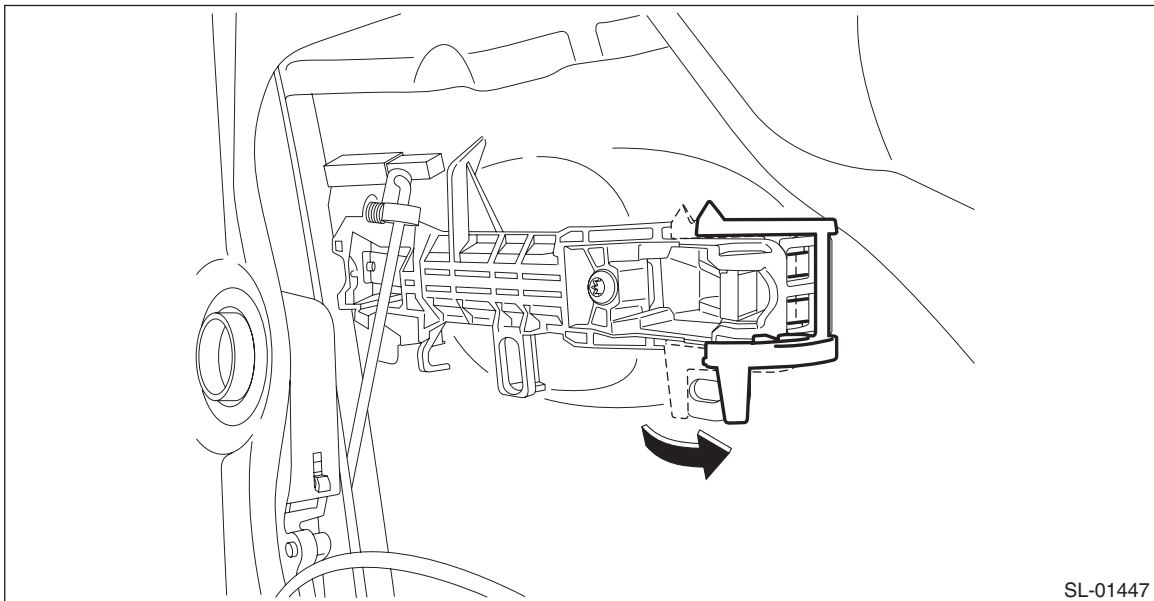

NOTE:

For model with keyless access, disconnect the harness clip and exterior antenna (touch sensor) connector.

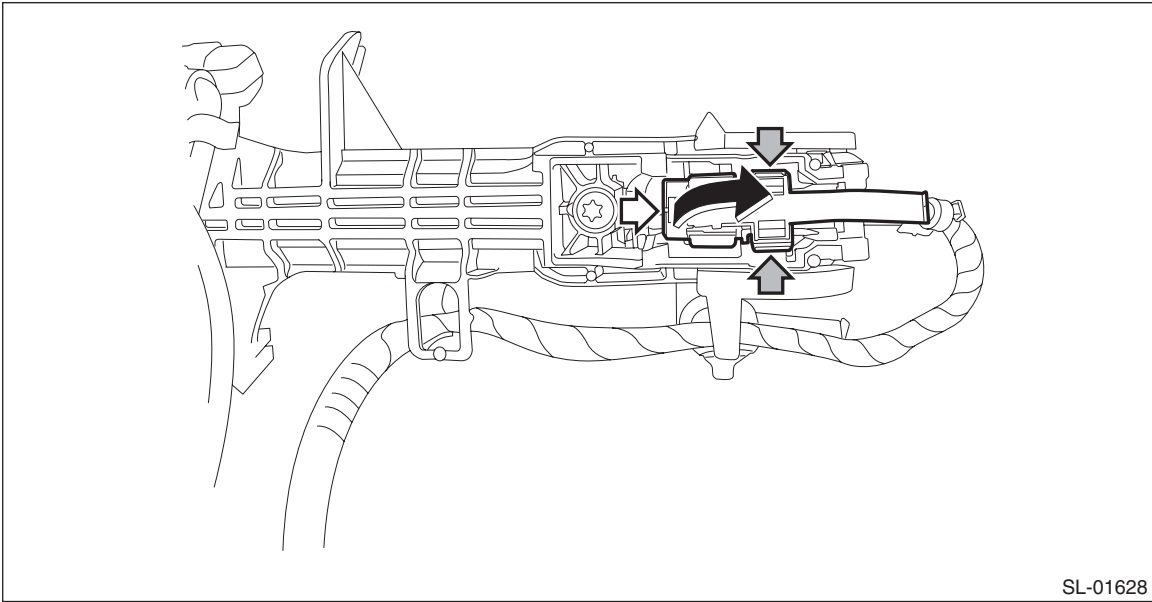

5) Remove the cover - handle front outer.

Preparation tool:

TORX® T30

- (1) Remove the plug at the rear end of the panel assembly - front door.
- (2) Loosen the TORX® bolt and remove the cover - handle front outer.

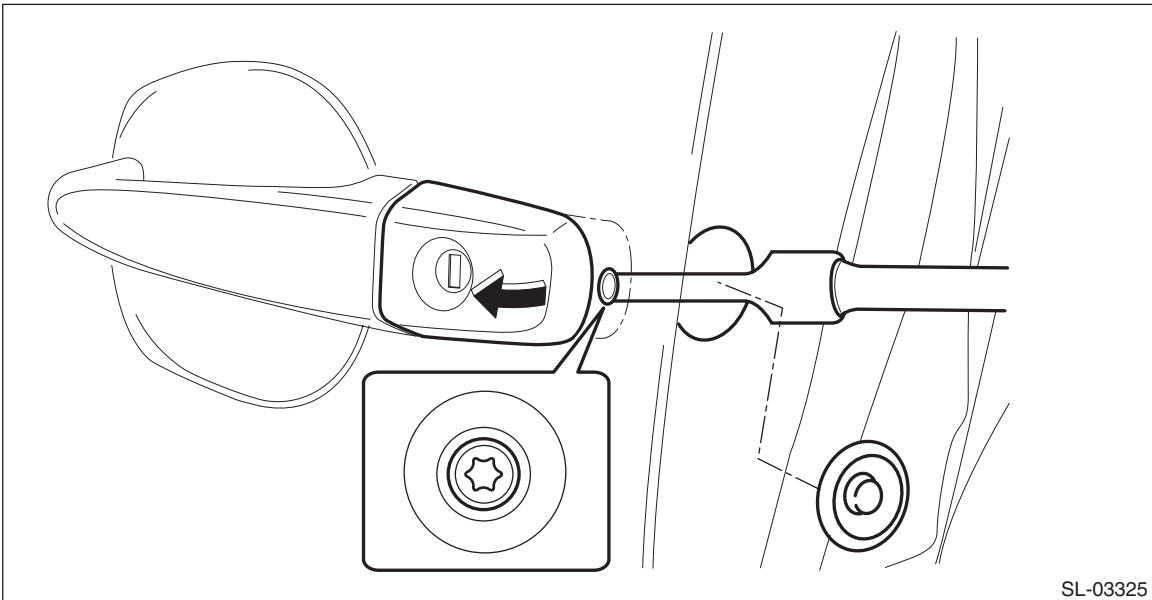

Front Outer Handle

SECURITY AND LOCKS

6) Remove the handle - door outer by moving it rearward.

CAUTION:

Do not apply excessive force to remove the handle - door outer from the panel assembly - front door. The panel assembly - front door may be deformed.

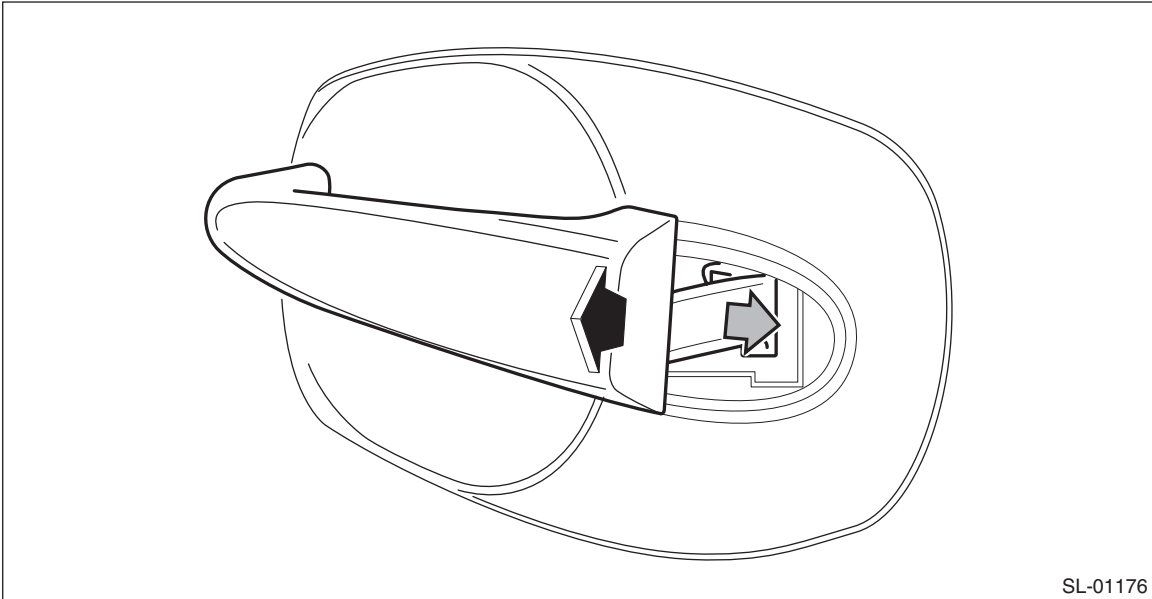

SL-01176

7) Remove the frame assembly - front door outer.

Preparation tool:

TORX® T30

(1) Remove the spacer - door handle outer.

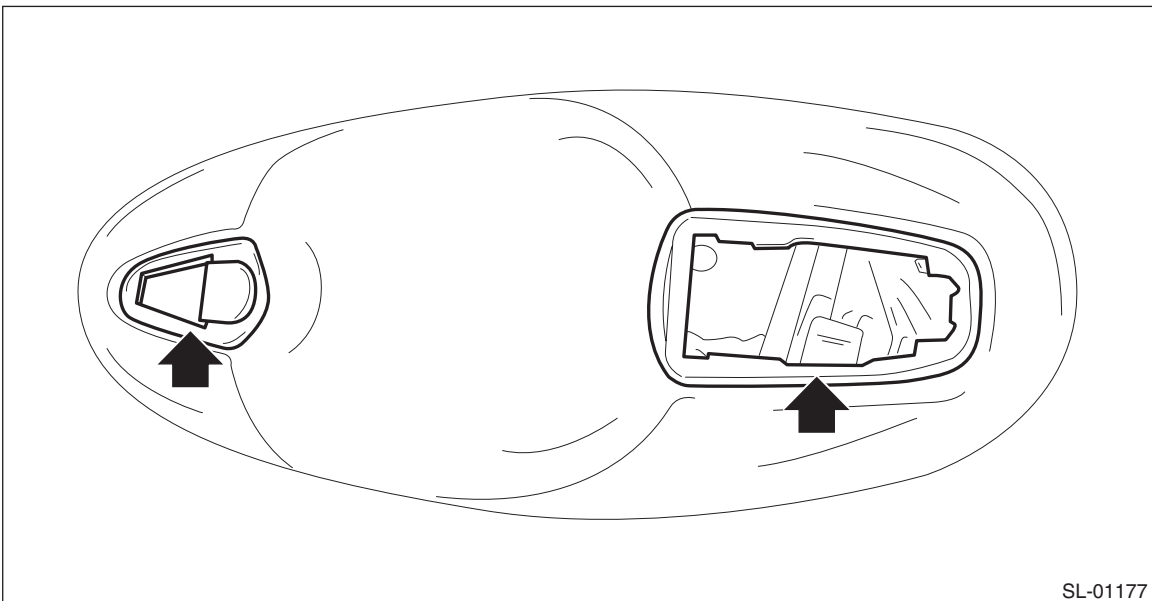

SL-01177

(2) Remove the rod from the rod clamp of the frame assembly - front door outer.

- (3) Loosen the TORX® bolt and remove the frame assembly - front door outer from inside the panel assembly - front door.

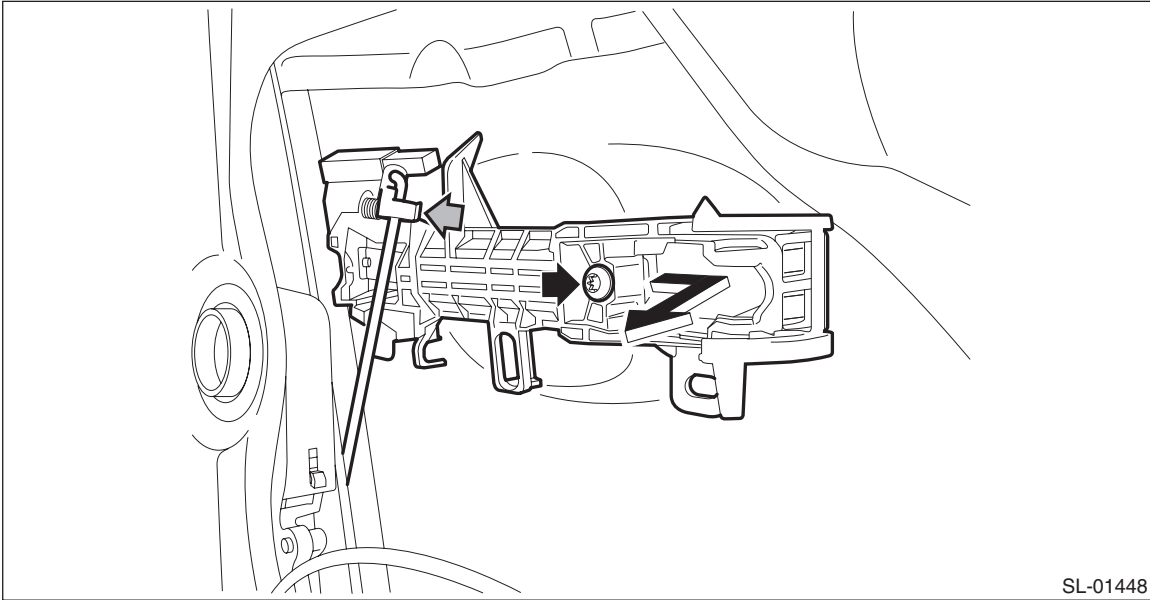

B: INSTALLATION

1) Before installation, check the following items.

- Rod is free from deformation.
 - Grease is applied sufficiently to rod joints.
- If grease is insufficient, add it as necessary before assembling the rod.
- If the lever is faulty, replace the front outer handle.
 - If the rod is deformed, replace the latch & actuator assembly - front.

2) Install each part in the reverse order of removal.

CAUTION:

When installing the cover - handle front outer on driver's side, make sure that the key cylinder shaft is correctly inserted into the latch & actuator assembly - front.

Tightening torque:

Refer to "COMPONENT" of "General Description". <Ref. to SL-2, DOOR LOCK ASSEMBLY, COMPONENT, General Description.>

C: INSPECTION

Check if the outer handle operates normally.

- If the lever is faulty, replace the handle - door outer.
- If the rod is deformed, replace the latch & actuator assembly - front.

For model with keyless access system, check that the keyless access function operates normally.

If the system does not operate normally, refer to "General Diagnostic Table" of the "KEYLESS ACCESS WITH PUSH BUTTON START SYSTEM (DIAGNOSTICS)" section. <Ref. to KPS(diag)-109, KEYLESS ACCESS SYSTEM, INSPECTION, General Diagnostic Table.>